

CERTIFIED RECORD OF LAND CORNER MONUMENTATION

**History of original corner establishment:**

Not previously established

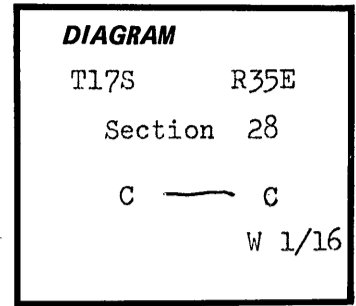

**Description of corner evidence found:**

At a point 50 feet west of the true corner location I found a steel fence post with a location tag on a nearby tree. Blazed lines run south and east from this point. Lines were evidently run by Bert Udell (no date) per location tag.

**Description of monument and accessories I established to perpetuate the original location of this corner:**

At the established corner location I set a standard F.S. aluminum monument consisting of a 3" disk mounted on a 2 1/2 x 30" pipe with a 4 x 4 1/2" footplate. Monument is set on a rocky outcropping and is surround by a mound of stone 30 inches high by 5 feet diameter. Disk on the monument is stamped as shown. Setting of monument was done on 6/1/81 and was witnessed by P. Zabala and S. Moss.

**New BT's established :-**

- a 10" Ponderosa Pine bears N. 36°30' E., 27.7 feet distant, scribed W 1/16, S 28, BT
- a 8" Ponderosa Pine bears S. 53° W., 14.8 feet distant, scribed W 1/16, S 28, BT

Both BT's are banded with red paint, carry BT and Attention signs and have brass disks stamped PLS 1287 nailed at the base of the BT blaze.

4

Steel fence posts with USFS boundary signs lie/feet south and 4 feet east of the corner monument.

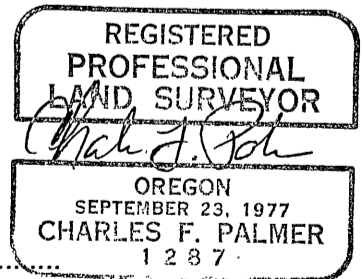
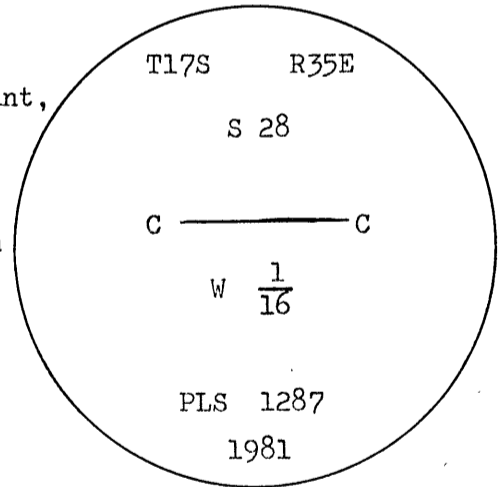

Office of Surveyor County of Grant  
 State of Oregon, I hereby certify that the within instrument was filed in this office  
 for record on the 23 day of Nov, 1982  
Robert D. Burnett by \_\_\_\_\_  
 (COUNTY OFFICIAL) (DEPUTY)